

BEFORE YOU DIG UTILITIES PROTECTION CENTER
CALL 811
 KNOW WHAT'S BELOW
 CALL BEFORE YOU DIG
 THREE WORKING DAYS BEFORE YOU DIG

#122C1 V010
 V/F
 PERTES LLC.
 3d C-G
 87 AC

FINAL PHASE NOTES

- THE FOLLOWING EROSION CONTROL MEASURES SHALL BE IMPLEMENTED DURING THE FINAL EROSION CONTROL PHASE OF CONSTRUCTION.
- SEDIMENT SHALL NOT BE WASHED INTO INLETS. IT SHALL BE REMOVED FROM THE SEDIMENT TRAPS AND DISPOSED OF AND STABILIZED SO THAT IT WILL NOT ENTER INTO THE INLETS AGAIN.
- MAINTAIN FULL COORDINATION WITH THE DESIGN PROFESSIONAL, CONTRACTOR AND REGULATORY INSPECTOR AT ALL TIMES REGARDING PROJECT SEQUENCE.
- MULCH OR TEMPORARY GRASSING SHALL BE APPLIED TO ALL EXPOSED AREAS WITHIN 14 DAYS OF LAND DISTURBANCE. ALL DISTURBED AREAS LEFT MULCHED AFTER 30 DAYS SHALL BE STABILIZED WITH TEMPORARY GRASSING.
- THE CONTRACTOR SHALL MAINTAIN ALL SEDIMENT PONDS AND EROSION CONTROL MEASURES UNTIL PERMANENT GROUND COVER IS ESTABLISHED.
- SEDIMENT SHALL BE CLEANED OUT OF PONDS WHEN IT REACHES THE HALF WAY POINT ON THE RISER.
- AFTER CURBING, GRADED AGGREGATE BASE, AND PAVEMENT HAS BEEN INSTALLED, ALL INLET SEDIMENT TRAPS ON SINGLE AND DOUBLE WING CATCH BASINS ALONG WITH ANY CURB INLETS SHALL BE REMOVED AND REPLACED WITH CURB FILTER INLET PROTECTION.
- ALL ROADWAY AND PARKING SHOULDERS SHOULD BE GRASSED AS SOON AS FINAL GRADE IS ACHIEVED BEHIND CURBS.
- SEDIMENT AND EROSION CONTROL MEASURES SHOULD BE CHECKED AFTER EACH RAIN EVENT. EACH DEVICE IS TO BE MAINTAINED OR REPLACED IF SEDIMENT ACCUMULATION HAS REACHED ON HALF THE CAPACITY OF THE DEVICE. ADDITIONAL DEVICES MUST BE INSTALLED IF NEW CHANNELS HAVE DEVELOPED.
- FAILURE TO INSTALL, OPERATE, OR MAINTAIN ALL EROSION CONTROL MEASURES WILL RESULT IN CONSTRUCTION BEING STOPPED ON THE JOB UNTIL SUCH MEASURES ARE CORRECTED BACK TO THE APPROVED EROSION CONTROL PLANS.
- EROSION CONTROL MEASURES WILL BE MAINTAINED AT ALL TIMES. IF FULL IMPLEMENTATION OF THE APPROVED PLAN DOES NOT PROVIDE FOR EFFECTIVE EROSION CONTROL, ADDITIONAL EROSION AND SEDIMENTATION CONTROL MEASURES SHALL BE IMPLEMENTED TO CONTROL OR TREAT THE SEDIMENT SOURCE AS DIRECTED BY THE ON SITE INSPECTOR OR THE DESIGN PROFESSIONAL.
- UPON COMPLETION OF THE PROJECT AND RECEIPT OF CERTIFICATE OF OCCUPANCY, THE CONTRACTOR SHALL REMOVE ALL TEMPORARY EROSION CONTROL MEASURES AND DISPOSE OF THEM UNLESS NOTED ON PLANS.

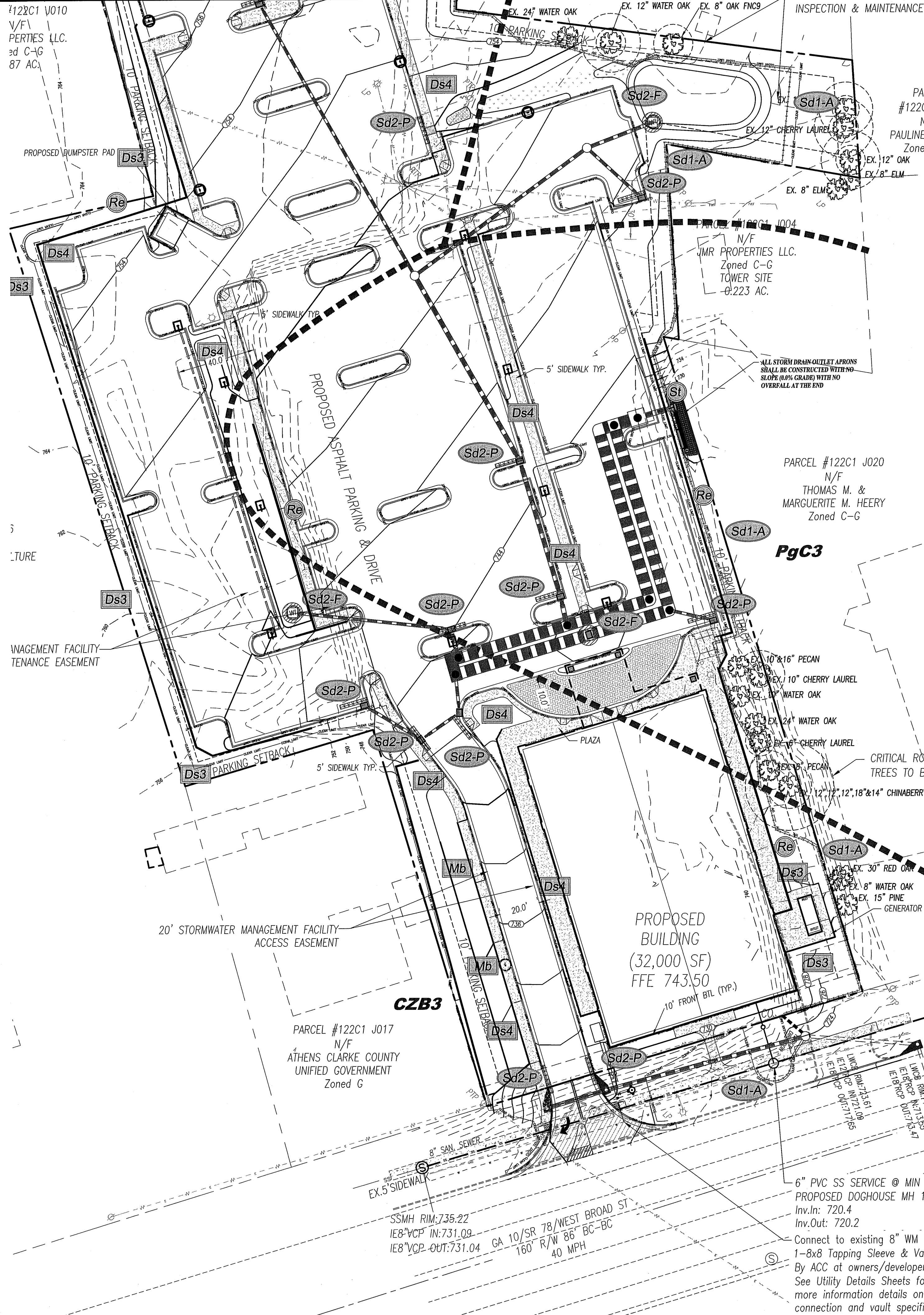

NRCS SOILS DATA:

MAP SYMBOL	SOIL TYPE	SLOPES	EROSION	DEPTH	PERMEABILITY	K FACTOR
C2S	Clay Sandy Loam	2-6%	Severely Eroded	>40"	0.2-2.0 in./hr.	0.32
C2S	Clay Sandy Clay Loam	2-6%	Severely Eroded	>40"	0.2-2.0 in./hr.	0.32
P2C	Fine Sand, Clay Loam	2-10%	Severely Eroded	>40"	0.2-2.0 in./hr.	0.50

EROSION & SEDIMENT CONTROL MEASURES SHALL BE ESTABLISHED PRIOR TO ANY OTHER CONSTRUCTION ACTIVITIES ON SITE. ALL EROSION & SEDIMENT CONTROL FACILITIES SHALL BE MAINTAINED UNTIL PERMANENT GROUND COVER IS ESTABLISHED.

STORMWATER MANAGEMENT SHALL BE IN ACCORDANCE WITH COUNTY, STATE AND OTHER APPROPRIATE ORDINANCES.

ANY AMENDMENT OR REVISION TO THE ESC PLAN THAT WILL AFFECT BMPs WITH A HYDRAULIC COMPONENT MUST BE CERTIFIED BY THE DESIGN PROFESSIONAL AND APPROVED BY THE APPROPRIATE REGULATORY AGENCY.

NON-EXEMPT ACTIVITIES SHALL NOT BE CONDUCTED WITHIN ANY 25-FOOT UNDISTURBED STREAM BUFFER, AS MEASURED FROM THE POINT OF WRESTED VEGETATION, WITHOUT FIRST ACQUIRING THE NECESSARY VARIANCES AND PERMITS.

ANY DISTURBED AREA LEFT EXPOSED FOR A PERIOD GREATER THAN 14 DAYS SHALL BE STABILIZED WITH MULCH OR TEMPORARY SEEDING.

EROSION CONTROL MEASURES WILL BE MAINTAINED AT ALL TIMES. IF FULL IMPLEMENTATION OF THE APPROVED PLAN DOES NOT PROVIDE FOR EFFECTIVE EROSION CONTROL, ADDITIONAL EROSION AND SEDIMENTATION CONTROL MEASURES SHALL BE IMPLEMENTED TO CONTROL OR TREAT THE SEDIMENT SOURCE. PRACTICES WILL BE CHECKED DAILY.

THE ESCAPE OF SEDIMENT FROM THE SITE SHALL BE PREVENTED BY THE INSTALLATION OF EROSION AND SEDIMENT CONTROL MEASURES AND PRACTICES PRIOR TO, OR CONCURRENT WITH, LAND DISTURBING ACTIVITIES.

WASHOUT OF THE CONCRETE TRUCK DRUM AT THE CONSTRUCTION SITE IS PROHIBITED.

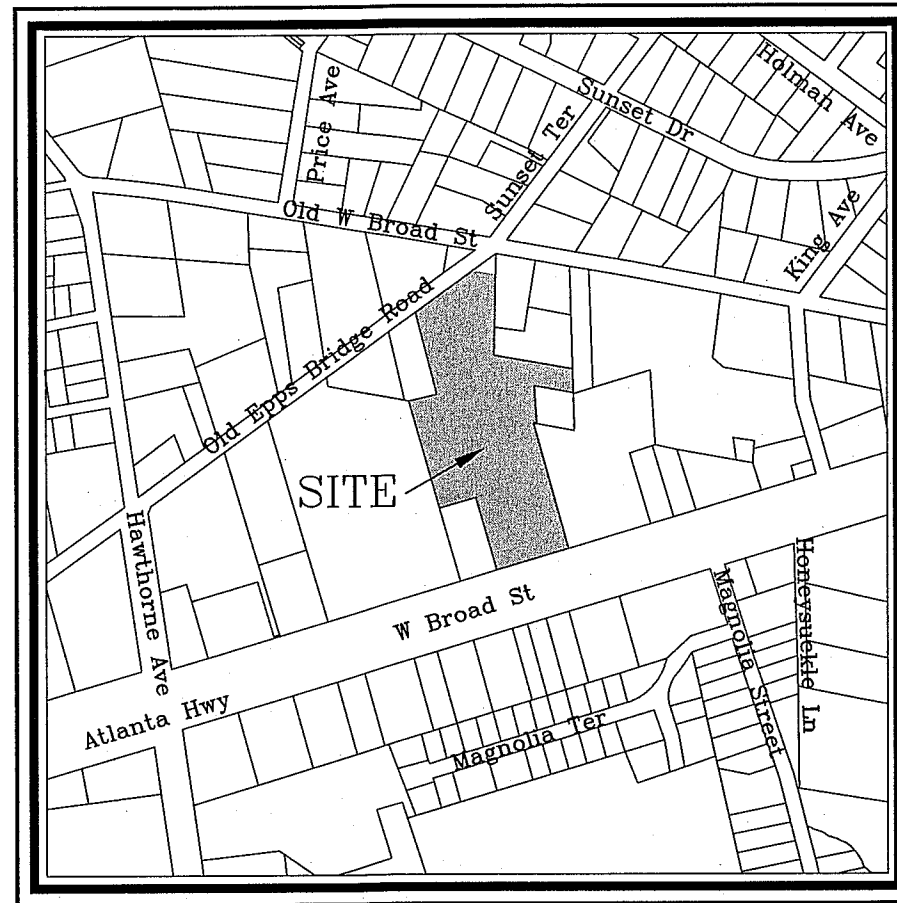

VICINITY MAP
 SCALE: 1" = 500'

PROJECT DATA:

OWNER: RODNEY L. PATTON
 130 OLD EPPS BRIDGE ROAD
 ATHENS, GEORGIA 30606
 ATTN: RODNEY PATTON
 (706) 354-0019

DEVELOPER: STANMORE DEVELOPMENT
 1044 NORTH US HIGHWAY ONE, SUITE 202
 JUPITER, FL 33477
 ATTN: JOHN MELTON
 (561) 459-3336

AUTHORIZED AGENT: WILLIAMS & ASSOCIATES
 LAND PLANNERS, P.C.
 2470 DANIELLS BRIDGE RD.
 SUITE 161
 ATHENS, GEORGIA 30606

PHYSICAL ADDRESS: 2142 WEST BROAD STREET

TAX PARCEL: 122C1 J018

CONTOUR INTERVAL: 2' FIELD RUN BY WILLIAMS & ASSOCIATES DATED JULY 8, 2010.

BOUNDARY SURVEY: THIS DRAWING WAS PREPARED USING AN ALTA/ACSM LAND TITLE SURVEY FOR CHICAGO TITLE INSURANCE COMPANY & STANMORE DEVELOPMENT, LLC. DATED JULY 8, 2010, BY WILLIAMS & ASSOCIATES.

EXISTING ZONING: C-G

TOTAL PROJECT ACREAGE: 4.425 AC

FLOOD PLAN: NO PORTION OF THIS PROPERTY LIES WITHIN THE FLOOD PLAN ACCORDING TO FIRM COMMUNITY PANEL NUMBER 13059C0024D & 13059C0025D DATED APRIL 2, 2007.

THERE ARE NO STATE WATERS ONSITE OR WITHIN 200' OF THE SITE.

THERE ARE NO WETLANDS DELINEATED ON SITE.

WATER SUPPLY: ACC PUBLIC UTILITIES
SEWAGE DISPOSAL: ACC PUBLIC UTILITIES
SOLID WASTE: BY PRIVATE HAULER
UTILITIES: POWER, GAS, WATER, SEWER, TELEPHONE, CABLE TV

24 HR CONTACT:
 STANMORE DEVELOPMENT
 1044 N. US HWY ONE, SUITE 202
 JUPITER, FL 33477
 ATTN: JOHN MELTON
 (561) 459-3336

NOTES:

- STORM WATER MANAGEMENT SHALL BE IN ACCORDANCE WITH COUNTY, STATE AND OTHER APPROPRIATE ORDINANCES AND REGULATIONS, IN EFFECT AT TIME OF CONSTRUCTION PLAN APPROVAL.
- A NOTICE OF TIMBER HARVESTING IS REQUIRED PRIOR TO CLEARING AND GRADING.
- ALL DEMOLITION TO COMPLY WITH ALL APPLICABLE LOCAL, STATE, AND FEDERAL LAWS AND REQUIREMENTS.
- NO MODIFICATIONS ARE PROPOSED TO THE BUILDING TO REMAIN.
- ALL STORM DRAIN OUTLET APRONS SHALL BE CONSTRUCTED WITH NO SLOPE (0.0% GRADE) WITH NO OVERALL AT THE END.

ENVIRONMENTAL BUFFERS NOTE
 ALL ENVIRONMENTAL BUFFERS SHALL BE CLEARLY DELINEATED IN THE FIELD BEFORE CLEARING AND GRUBBING BEGINS

BENCHMARK
 BENCHMARK IS TOP OF EXISTING IRON PIN FOUND AT THE NORTH EAST PROPERTY CORNER. TOP ELEVATION = 757.64

- EROSION AND SEDIMENT CONTROL NOTES**
- IF SEASONAL LIMITATIONS DELAY PLANTING OF GRASS THEN STRAW MULCH STABILIZATION SHALL BE PLACED IN ACCORDANCE WITH COUNTY STANDARDS.
 - THE CONSTRUCTION OF THE SITE WILL COMMENCE WITH THE INSTALLATION OF EROSION CONTROL MEASURES SUFFICIENT TO CONTROL SEDIMENT DEPOSITS AND EROSION.
 - STANDARDS AND SPECIFICATIONS: ALL DESIGNS WILL CONFORM TO AND ALL WORK WILL BE PERFORMED IN ACCORDANCE WITH THE STANDARDS AND SPECIFICATIONS OF THE PUBLICATION ENTITLED "MANUAL FOR SOIL EROSION AND SEDIMENT CONTROL IN GEORGIA".
 - ADDITIONAL EROSION CONTROL MEASURES WILL BE EMPLOYED WHERE DETERMINED NECESSARY BY ACTUAL SITE CONDITIONS AND/OR AS SPECIFIED BY THE ACC INSPECTOR.
 - ACCUMULATED SILT SHALL BE REMOVED WHEN IT REACHES A DEPTH OF 6" AT THE EROSION PROTECTION DEVICE.
 - ALL SEDIMENT CONTROL SHALL BE MAINTAINED UNTIL ALL UPSTREAM GROUND HAS BEEN COMPLETELY STABILIZED WITH PERMANENT VEGETATION.
 - ALL CONSTRUCTION IS TO BE IN ACCORDANCE WITH STATE LAWS AND LOCAL ORDINANCES AND SPECIFICATIONS. IT IS THE CONTRACTOR'S RESPONSIBILITY TO NOTIFY ACC OFFICIALS OF ALL REQUIRED INSPECTIONS.
 - THE CONSTRUCTION EXIT SHALL BE MAINTAINED IN A CONDITION WHICH WILL PREVENT TRACKING OF MUD ONTO PUBLIC RIGHTS OF WAY.
 - ALL CONSTRUCTION CONTRACTORS MUST OBSERVE THE LIMITS OF CONSTRUCTION OR DISTURBANCE AS SHOWN.
 - MULCH WHERE NECESSARY WILL BE APPLIED AT A RATE OF 2 1/2 TONS PER ACRE.
 - 6/12/12 FERTILIZER SHALL BE APPLIED AT A RATE OF 1500 POUNDS PER ACRE TO REVEGETATED AREAS. APPLY LIME AT A RATE OF 2 TONS PER ACRE.
 - ALL SILT FENCE IS TYPE "A" UNLESS OTHERWISE SPECIFIED.
 - INSTALL GEOTEXTILE LINER UNDERNEATH CONSTRUCTION EXIT AS SHOWN IN DETAIL ON UNIFORM CODING SHEET.
 - WASHOUT OF THE CONCRETE TRUCK DRUM AT CONSTRUCTION SITE IS PROHIBITED.

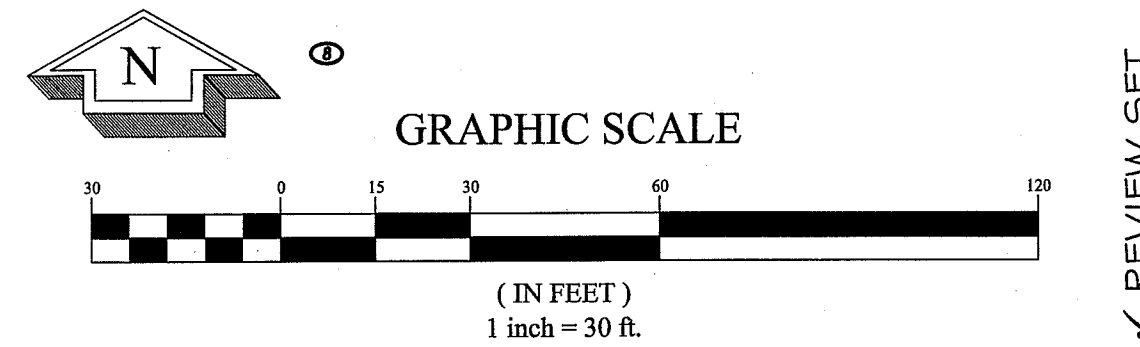

SEDIMENT AND EROSION CONTROL CHECKLIST ITEMS CORRESPOND TO ①

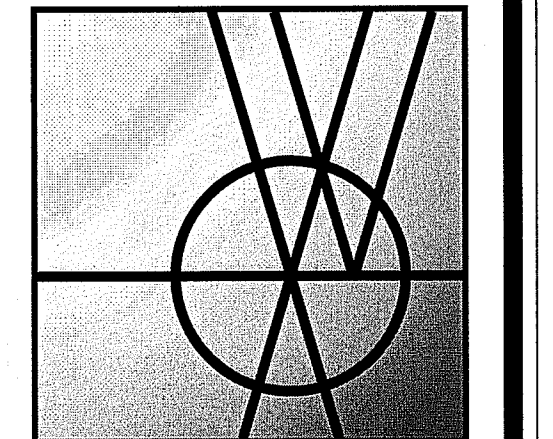

Williams & Associates

ENGINEERING • SURVEYING
 LANDSCAPE ARCHITECTURE

2470 Daniels Bridge Road, Suite 161
 Athens, Georgia 30606
 P. 706.310.0400
 F. 706.310.0411

www.gaplaning.com

ATHENS MEDICAL COMPLEX
 ATHENS-CLARKE COUNTY, GEORGIA
 4.425 ACRES - WEST BROAD STREET

DATE: 03/01/2011

REVISIONS

DATE	COMMENT
03/01/11	Per generator pad and enclosure addition and planning comment.
04/29/11	Per field change to bioretention pond.
05/12/11	Per ACC/PW comments on field change to bioretention pond.

GSWCC LEVEL II
 CERTIFICATION # 3588

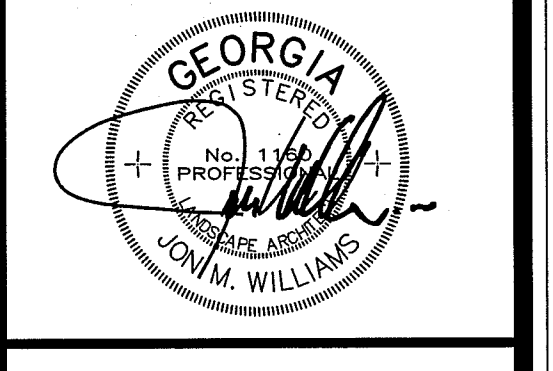

ALL DRAWINGS SHALL REMAIN THE PROPERTY OF WILLIAMS & ASSOCIATES. THESE INSTRUMENTS OF SERVICE ARE TO BE USED SOLELY FOR THIS SPECIFIC PROJECT. WILLIAMS & ASSOCIATES SHALL RETAIN ALL LEGAL RIGHTS TO THE USE OF THE INSTRUMENTS OF SERVICE AND SHALL RETAIN FULL PROTECTION UNDER UNITED STATES COPYRIGHT LAW.

10047
 ES&PC PLAN
 PHASE 3

09